



J&M EQUIPMENT CATALOG

DEEP FOUNDATION
SOLUTIONS



800-248-8498

WWW.APEVIBRO.COM



COMPANY PROFILE

J&M Foundation Equipment Getting the Job Done

30 years of excellence, and always J&M. Though we have designed and manufactured LBF, ICE & HMC brand equipment, the engineering expertise, and the invaluable experience gained, has always resided at J&M. Building our future on this foundation, and a commitment to customer satisfaction, the J&M name will always mean advanced design, extreme reliability and cost effective value. Couple this with a huge parts inventory, in house engineering, machining and fabrication; and no job is too special, no delivery is too stringent, and down time is not an option.

**Vibratory Pile Driver/Extractors
Hydraulic Impact Hammers
Top Drive Earth Augers**

J&Ms proven concept of modularity provides exceptional flexibility for both customer operations and the J&M rental fleet. By designing our power units to operate various types of foundation equipment, maximum utilization, availability and value are achieved. A typical J&M power unit can operate a vibratory driver, a hydraulic impact hammer, an auger, a pile crusher and a submersible pump, without modification or special controls.



CONTENTS

COMPANY PROFILE	3
POWER UNITS	4
VIBRATORY DRIVER/EXTRACTORS	6
HYDRAULIC IMPACT HAMMERS (HIH)	8
HYDRAULIC AUGERS	10
3030 DRILL MASTS	11
ROBOVIB DRIVER/EXTRACTORS	12
J&M HAMMER ACCESSORIES	14



POWER UNITS

Designed for efficiency, J&M power units achieve reliability through simplicity of design and heavy duty construction. Caterpillar™ engines are used exclusively in light of their unmatched world wide parts and service capability. Similarly, only highest quality, name brand, readily available, hydraulic and electrical components are selected. Safety, component protection, and ease of maintenance are built in. J&M units are exclusively filled with non-toxic, biodegradable Clarity™ mineral oil, making them environmentally friendly without sacrificing exceptionally long fluid and hydraulic component life. Dual controls (one on the remote pendant and another on the control panel) keep your job running even if the pendant is damaged. Radio remote (wireless) control is a plug in option. Easily adaptable to operate non-J&M equipment, J&M power units provide maximum value in operation and resale.

POWER UNIT SPECIFICATIONS

Model	Units	33	51	127	200	230	310	315	375	595
Engine-Caterpillar	model	C1.5	C2.2	C4.4	C6.6	C6.6	C9	C9	C9	C15
Power	hp	33	51	127	200	230	375	375	375	595
Drive Pressure	psi	2500	2500	2500	2500	4500	3500	5000	5500	4500
Drive Flow	gpm	20	32	60	100	70	135	87	87	155
Clamp Pressure	psi	--	--	--	2500	4500	--	--	4500	4800
Clamp Flow	gpm	--	--	--	10	10	--	--	5.2	6.5
Speed	rpm	3000	3000	2200	2200	2200	2200	2200	2200	2100
Weight	lbs	1500	3000	4750	9600	9600	9100	9600	10485	15400
Length	in	40.25	68	99	126	126	137	137	126	158
Width	in	36.13	40	45	60	60	60	60	60	73
Height	in	54.63	50	66	80	80	75	75	80	95
Hydraulic Reservoir	gal	30	55	140	280	280	270	270	280	385
Fuel Capacity	gal	12	24	75	130	130	110	110	130	150



VIBRATORY DRIVER/EXTRACTORS

INNOVATION IN VIBRATION Exceptional speed durability and value, plus a wide range of models, insures profitability for every job type.

Standard Vibratory Driver / Extractors

- 30 years of innovation and refinement insure reliability
- Variable frequency, weight & line pull for job matching
- Vibrator moment optimized for available horsepower
- Largest selection of clamps and accessories in the industry
- Forged high alloy gears are precision ground
- On hammer brake minimizes boom shake
- High efficiency, bent axis, piston motors
- Gun drilling and machined manifolds eliminate leaks
- Proper bearings and lubrication insure long life
- Open loop hydraulics for efficiency and reliability
- Quickly adaptable for underwater or low head room applications
- Remote speed control and emergency stop on pendant
- Clamp cylinders machined from solid & include lock valve



VIBRATORY DRIVER / EXTRACTOR SPECIFICATIONS

Model	Units	23-51	23E	216	216E	11-23	22-30	28-35	416	44-50	44-65	66-80	1412	1412T
Eccentric Moment	in lb	230	230	1100	1100	1100	2200	2800	2200	4400	4400	6600	10000	20000
Frequency	vpm	1600	1600	1600	1600	1900	1650	1650	1600	1600	1650	1560	1250	1250
Amplitude	in	0.58	0.58	0.94	0.94	0.94	0.98	1.17	0.98	1.17	1.17	1.23	1.3	1.3
Max Extraction Pull	tons	13	19.5	40	30	40	80	75	40	80	80	80	150	300
Max Bare Hammer Weight	lbs	1520	2000	4230	3700	4390	6810	9180	7720	12400	12400	15330	25900	60000
Length	in	26	42	58	56	58	92	92	95	97	97	97	96	106
Width	in	16	18	16	17	18	22	22	17	22	22	22	41	84
Throat Width	in	10.5	10.5	12	14	13.25	15	15	14	14.25	14.25	14.25	32	64
Height w/o clamp	in	42	50	69	65	69	70.25	70.25	69	83	83	100	148	156
Power Unit	model	51	-	200	-	230	375	375	375	580	700	700	950	2 x 950

Excavator Mounted Vibratory Driver / Extractors

- Most powerful excavator mount vibratory driver available
- Attaches in minutes using bucket circuit only
- Minimum suspended weight

- 360 degree swivel
- No excavator hydraulics modification required
- Up to 45 Tons extraction pull
- Matched to excavator with no additional heat load
- Safety stops in suppressor & excavator connection
- Quiet operation for urban setting
- Made in USA



HYDRAULIC IMPACT HAMMERS (HIH)

Hydraulic Efficiency, Power and Control for Impact Hammers

- Single piece, chrome alloy, forged ram – non-segmental
- 100% hydraulic, infinitely variable, stroke control system
- Elastomeric cylinder to ram, anti-shock, connection
- No threaded fasteners permitted on ram forging.
- Forged, alloy steel, striker block & standard drive caps
- Proven and ultra-rugged, 4-column, tensioned cable frame
- Piston style accumulators.
- Hard-chromed columns and self-lubricating ram bearings
- Optional wireless energy readout – downloadable
- Compatible with other hydraulic sources
- No wires, no sensors, no computers, no problem



HYDRAULIC IMPACT HAMMER SPECIFICATIONS

Model	Units	70	115	160	220	275	345
Ram Weight	lbs	7000	11500	16000	22000	27500	34500
Maximum Stroke	feet	3	4	4	4	4	4
Minimum Stroke	feet	1	1	1	1	1	1
Hammer Weight (bare)	lbs	13400	17000	28600	35000	47650	54650
Hyd. Hose Length	feet	100	100	100	100	100	100
Hyd. Hose Weight	lbs	850	850	1340	1340	1340	1500
Depth	inches	38	36	46	48	54	60
Width	inches	20	26	32	32	36	36
Height (bare)	ft-in	15'-5"	19'-9"	20'-3"	20'-3"	22'-8"	22'-8"
Power Unit	model	108H	175	230	335	335	570

HYDRALIC AUGERS

- Single speed, two speed or Autotorque
- Pre-drill, tie backs, cast in place, soil nails, mini-piles
- Bolted flange, Hex or API fighting connections
- Oversize roller bearings on output shaft for crowd
- Easy shaft seal replacement in field
- Heavy duty final drive gears practically indestructible
- Lifting bale with or without sheave
- Roller or angle lead guides for 20", 27", 33"
- Compatible with other hydraulic sources
- Autotorque has ultra low speed for grouting & DHH
- 3", 4", 6" through hole in output shaft
- Rotary joint and plumbing for grout and fluid injection
- Grout hose connection via Victaulic™ connectors



3030 DRILL MASTS

The Model 3030 Drill Mast turns your excavator into a powerful drilling machine with impressive standard features:

- 30 feet of linear auger travel
- 30" maximum fighting diameter
- 30,000 ft. lb. allowable auger torque
- 30,000 lb of extraction force via top mounted winch
- 15,000 lb of crowd force via rear mounted winch
- Uses J&M Model 3060 auger drive or equal
- Fore and aft mast angle adjusted by excavator cylinder
- Left & right mast angle adjustment $\pm 10^\circ$
- Optional 3" grout swivel
- All drilling functions controlled by existing joy sticks
- No modifications to excavator hydraulic system or controls
- Locking valves prevent cylinder drift
- Pressure control & diverting valves on mast
- Self erecting



HYDRALIC AUGER SPECIFICATIONS											
Model	Units	760	1255	3062	3060	3063	3061	3064	35AT	5050	55AT
Speed Control	type	Single	Single	Single	Single	Single	Single	Single	Auto Var	Two Spd	Auto Var
Maximum Torque	ft lb	7,000	12,500	15,200	21,000	22,000	31,400	32,000	32,400	54,300	54,800
Max (>Min) Speed	rpm	60	60	65	60	60	41	41	72>47/13	50/25	73>25/7
Shaft ID	in	2.50	4.00	4.00	4.00	4.00	4.00	4.00	4.00	7.38	7.38
Grout Swivels	in	3"	3" 4"	3" 4"	3" 4"	3" 4"	3" 4"	3" 4"	3" 4"	3" 4" 6"	3" 4" 6"
Maximum Crowd \pm	lbs	20,000	35,000	35,000	35,000	35,000	35,000	35,000	35,000	80,000	80,000
Weight (with hoses)	lbs	2,200	3,500	3,500	3,500	3,500	3,500	3,500	3,500	3,900	3,900
Hyd Hose Length	feet	100	100	100	100	100	100	100	100	100	100
Hyd Hose Weight	lbs	500	500	500	500	500	500	500	500	500	500
Depth	in	17	38	38	38	38	38	38	38	38	38
Width	in	20	26	26	26	26	26	26	26	26	26
Height	in	46	52	52	52	52	52	52	52	52	52
Power Unit	model	108	175	230	310	335	310	335	315*/335	335	315*/335

Single = Single Speed Two Spd = Two Speed Auto Var = AutoTorgue * = Allows Low Low Speed

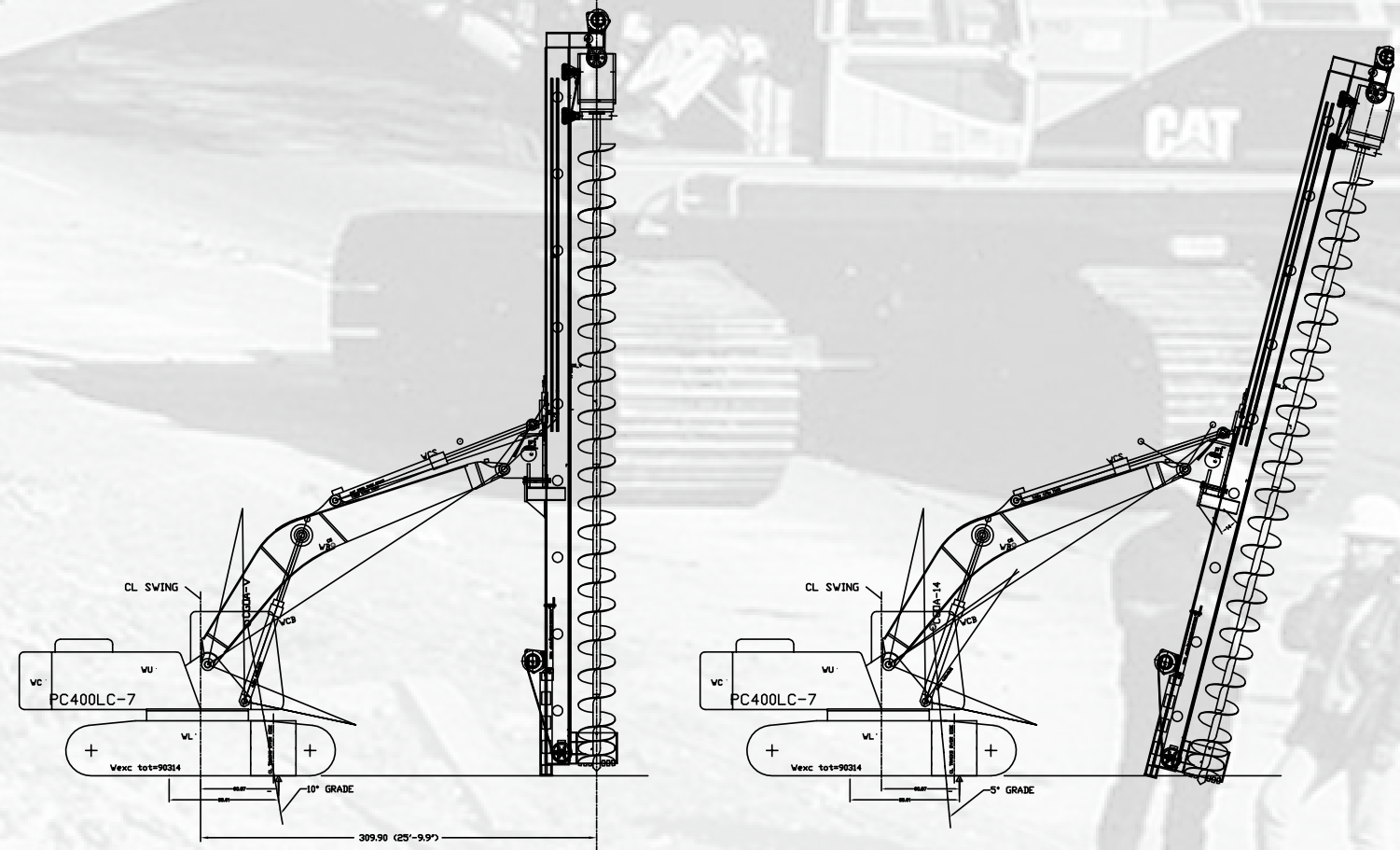

ROBOVIB DRIVER/EXTRACTORS

These excavator-mounted vibros allow a single operator to unload H and I beams and sheet piles, raise them to the vertical, position them precisely, and drive them to grade -- all with NO extra equipment needed, and with superior speed and power. APE RoboVib

Powered by excavator hydraulics and fully articulated, RoboVib drives piles up to 40' long, much more economically and with greater safety than conventional crane-handled methods. Efficient, built for long life and heavy duty, and able to drive piles from the side or from the top, RoboVib answers the need for a reliable excavator-mounted vibratory driver.



- The ROBOVIB eccentrics are located within the fixed side grip arm. Centerline of dynamic force is much closer to the gripping jaws, reducing off center force input to pile.
- Vertical distance between side grip jaws is increased to better resist off-center force
- ROBOVIB eccentric moment is 22% greater than competitive units, producing significantly larger driving amplitude.
- Each clamp has an individual actuating cylinder. No poorly guided, trouble prone, dual purpose cylinders as in competitive units
- Side grip cylinders are directly mounted to arms and are hydraulically synchronized.
- Proven tilt and rotate mechanism is designed for digging duty, and has sealed lubrication for bearings and worm gear. Cast housing and integral rotation motor maintain perfect alignment for worm gear and massive rotation bearing. Dual tilt cylinders are telescopic, providing lower profile and equal left and right tilt torque.
- ROBOVIB +/- 40 deg tilt is 33% more than the competition, allowing additional reach when loading or unloading piles.
- Rectangular clamp jaws on side grips provide more clamping area than round jaws.
- Bottom clamp uses precision-guided slider per accepted vibratory hammer practice. Clamp cylinder is directly aligned with the fixed jaw - no offset.
- Most components contained within welded steel frame for protection and exceptional strength.
- No solenoid valves or wiring mounted on ROBOVIB. Valves and wiring are remotely mounted on excavator boom to avoid vibration damage.
- Both the side grip and the bottom clamp jaws are identical to minimize inventory. Additionally, all ROBOVIB jaws have the J&M exclusive "Kryponite" coating for exceptional wear life.
- Three eccentrics are vertically stacked to minimize distance between driving force and pile center.
- Commonly available elastomers isolate vibration from excavator. Extra elastomer mounting positions are provided so spring rate may be optimized for tough pile extraction applications.
- Lockable adjusting nuts eliminate clearance in side grip arms to reduce vibration wear, and insure long life
- Commercial, high pressure gear motor is interchangeable to exactly match excavator hydraulic flow to ROBOVIB. No flow controls or restrictions to cause damaging heat buildup in excavator hydraulic system.
- Gun-drilled hydraulic distribution manifold is integral to suspension yoke to minimize plumbing, and perfectly align hydraulic swivel.
- Replaceable offset bushings at the excavator connection allow pin diameter and center distance changes to accommodate various brands and sizes of excavators.
- Minimum width, fixed side clamp arm allows driving of H-piles as small as 10".

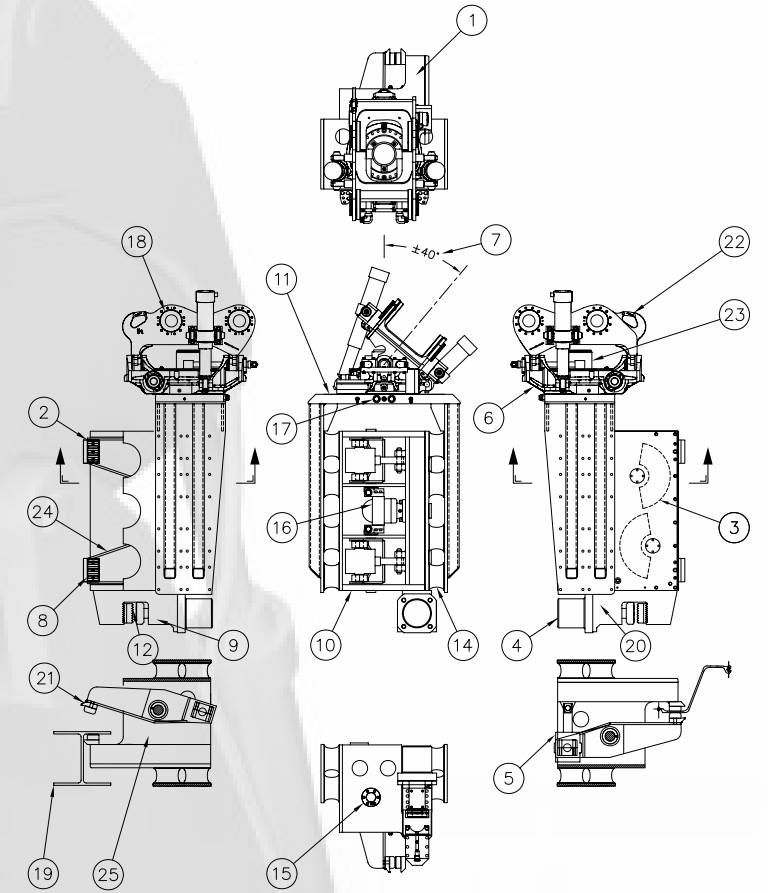

J&M HAMMER ACCESSORIES

218 Pile Crusher

- 200 ton crushing force
- Extra heavy duty construction – NO CASTING
- Heat treated, alloy, steel blades
- Replaceable, abrasion resistant, blade guides
- NFPA standard, repairable, hydraulic cylinders
- Machined manifolds replace vulnerable plumbing
- Low hydraulic operating pressure for long life
- Special cylinder rod seals exclude dirt and abrasives
- Chain suspension contains pile
- Universal blades Crush 12" thru 18" square piles
- Spacer stroke adjustment insures consistency
- Powered with J&M Model 175 power unit, or equal



LOW HEAD ROOM VIBRATORS					
Specifications	Units	216S	416S	44S	
Eccentric Moment	in lb	1,100	2,200	4,400	
Height with Clamp	in	45	59	68	
Width	in	90	114	140	
Depth	in	17	18	21	
Throat Depth	in	14	13	18	
Weight with Clamp	lb	3400	4700	9300	
Line Pull	tons	10	14	28	



CAISSON BEAMS					
Model	Compatibility	Range	Clamp	Weight	L x W x D
3'	216,216E,11-23,22-23	16"Ø-36"Ø	80	725	63"
4'	1412	22"Ø-50"Ø	122	945	9"x80"x6"
7'	416,44-30,44-50	16"Ø-84"Ø	80	1400	9"x110"x6"
10'	1412	22"Ø-130"Ø	122	5300	25"x150"x17"
11'	416,44-*,66-65	16"Ø-120"Ø	80	6725	19"x150"x17"
8Q	1412T	48"Ø-96"Ø	122	9900	12"x96"x56"
14Q	1412T	96"Ø-168"Ø	122	28600	33"x182"x91"



LEAD SPOTTERS				
Specifications	Units	100B	150B	368
Hydraulic Extension	ft.	10	20	30
Manual Extension	ft.	10	0	0
Extend Force	lb	18,000	28,000	60,000
Retract Force	lb	19,000	32,000	62,000
Retracted Length	ft.	17	17	26
L/R Travel Extended	ft.	6	35	52
L/R Force Extended	lb	7,200	12,000	28,000
L/R Travel Retracted	ft.	6	15	23
L/R Force Retracted	lb	7,200	25,900	64,000
Maximum Width	ft.	8	8	10
Maximum Pressure	psi	1,500	2,500	2,500
Weight	lb	7,000	8,500	31,100
Power Lead Rotator	--	Option	Option	Option



VIBRATOR ACCESSORIES						
Model	Type	Clamps	Pressure	Weight	L x W x D	Compatibility
10'	Clamp Extension	126,127,55	---	2300 lb	120"x37"x14"	416,44-*,66-65
40'	Clamp Extension	126,127,196,55	---	16400 lb	480"x37"x17"	416,44-*,66-65
90°	Turning Plate	126,127	---	1100 lb	4"x37"x37"	416,44-*
Db1	Diverting Valve	---	6000	80 lb	6"x7"x12"	Vibro,Auger,HIH
Db1	Diverting Sol. Valve	---	5000	250 lb	16"x12"x6"	Vibro,Auger,HIH
Db1	Inline Cross Relief	---	5000	30 lb	6"x6"x14"	Vibro,Auger,HIH
3300	Hydraulic Wrench	ALL	5000	9 lb	3"x8"x5"	1" hex, 1" sq drive



HYDRAULIC CLAMPS						
Model	Type	Range	Max Force	Weight	L x W x D	Compatibility
126	Sheeting	0-1.50"	126 Ton	2,200	38"x46"x12"	416,44-*,66-65
196	Sheeting	0-2.00"	196 Ton	2,850	38"x57"x12"	66-80,1412
127	Single "Z" Pile	12"&13" Deep	127 Ton	3,200	41"x48"x15"	416,44-*
80	Tube	16"Ø-132"Ø	80 Ton	1,000	22"x28"x11"	416,44-*,66-65
122	Tube	22"Ø-120"Ø	126 Ton	1,700	25"x58"x14"	66-80,1412
C102	Wood	6"Ø-15"Ø	45 Ton	3,200	40"x50"x32"	216,216E,11-23,22-23
55	Wood/Pipe/Concrete	8"Ø-19"Ø/20"	53 Ton	5,000	79"x43"x27"	416,44-*,66-65
165	Concrete	18"-25"	175 Ton	12,000	85"x77"x34"	416,44-*,66-*,1412

BRANCH LOCATIONS

APE CORPORATE

7032 South 196th Street
Kent, WA 98032
Ph: (253) 872-0141
Fx: (253) 872-1010
(800) 248-8498

APE CANADA

1002 7th Street
Nisku, Alberta T9E 7P2
Ph: (780) 474-9888
(855) 328-9888

APE WEST COAST

2985 Loomis Road
Stockton, CA 95205
Ph: (209) 942-2166
Fx: (209) 942-2455
(888) 245-4401

APE BRAZIL

Rodovia Raposo Tavares Km, 22
Sala 517- Bloco E
Granja Vianna-Cotia-SP
Ph: 55 11 97238 9308
(863) 660-8716

APE MID-WEST

50 Gerber Industrial Dr
St. Peters, MO 63379
Ph: (636) 397-8400
Fx: (636) 278-4278
(877) 296-8044

APE MEXICO

Ph: (786) 991-6875
Fx: (253) 872-8710

APE NORTHEAST

401 Hartle Street
Sayreville, NJ 08872
Ph: (732) 432-6604
Fx: (732) 432-6608
(888) 217-7524

APE GULF

3975 FM Hwy 1485
Conroe, TX 77306
39266 Doyle Drive
Gonzales, Louisiana 70737
Ph: (936) 271-1044
Fx: (936) 271-1046
(800) 596-2877

APE MID-ATLANTIC

500 Newtown Road, #200
Virginia Beach, VA 23462
Ph: (757) 518-9740
Fx: (757) 518-9741
(866) 399-7500

FAE SINGAPORE

Ph: (65) 6863-1633
Fx: (65) 6863-1455

APE SOUTHEAST

1345 Industrial Park Rd.
Mulberry, FL 33860
Ph: (863) 324-0378
Fx: (863) 318-9409
(800) 570-3844

APE RUSSIA

Ph: 7-495-603-5345
Fx: 7-495-603-5345

IMECO AUSTRIA

Ph: (43) 1328-9980
Fx: (43) 1328-9944

APE CHINA

Ph: 011-86-21-5677-1221
Fx: 011-86-21-3604-0553

The APE product line is protected by, but not limited to the following patent numbers:
5088565A, 5117925A, 5263544A, 5529132A, 5544979A, 5609380A, 5653556A,
5794716A, 6039508A, 6386295B1, 6427402B1, 6431795B2, 6447036B1, 6543966B2,
6648556B1, 6672805B1, 6732483B1, 6736218B1, 6896448B1, 6908262B1, 6942430B1,
6988564B2, 7168890B1, 7392855B1, 7694747B1, 7708499B1, 7824132B1, 7854871B1,
7913771B2, 7950876B2, 7950877B2, 8070391B2, 8181713B2, 8186452B1, 8434969B2,
8496072B2, 20090200055A1. For a more detailed information and a more comprehensive
list of APE patents please visit the website at www.apevibro.com/ver2/APEpatents.asp.

800-248-8498

WWW.APEVIBRO.COM

